

11" High, Drawer Extends to 22" Depth	MODEL
<ul style="list-style-type: none"> <li>◆ 635± CFM @ 1.5 to 4.6 Sones</li> <li>◆ 7" Round Duct, 4.25" Off Center</li> <li>◆ Hood Body: WH=White, BL=Black</li> <li>◆ Wood Front Ready. Wood Front Provided by Home Owner.</li> </ul>	WHITE 3030PS1-WH 3036PS1-WH 3042PS1-WH BLACK 3030PS1-BL 3036PS1-BL 3042PS1-BL
<ul style="list-style-type: none"> <li>◆ 760± CFM @ 1.5 to 4.6 Sones</li> <li>◆ 8" Round Transition, 4.25" Off Center</li> <li>◆ Hood Body: WH=White, BL=Black</li> <li>◆ Wood Front Ready. Wood Front Provided by Home Owner.</li> </ul>	WHITE 3030PS1-8-WH 3036PS1-8-WH 3042PS1-8-WH BLACK 3030PS1-8-BL 3036PS1-8-BL 3042PS1-8-BL

## FEATURES:

- ◆ Variable or Rocker Controls.
- ◆ Lighting: 75 Watt Max Incandescent. (Not Included)
- ◆ Filters: Aluminum Mesh
- ◆ Heat Controlled Thermostat, Fire Safety Controlled. Activates at 130 degrees. (On PS1 model only).
- ◆ Electrical: 115 AC, 60 Hz, 9 Amps. For proper installation, unit must be hard wired. Suggested use with 15 Amp Circuit.
- ◆ Installation: Included Mounting Screws.
- ◆ Suggested Distance Code: 36" above cooking surface. SD2 can be mounted at 30".

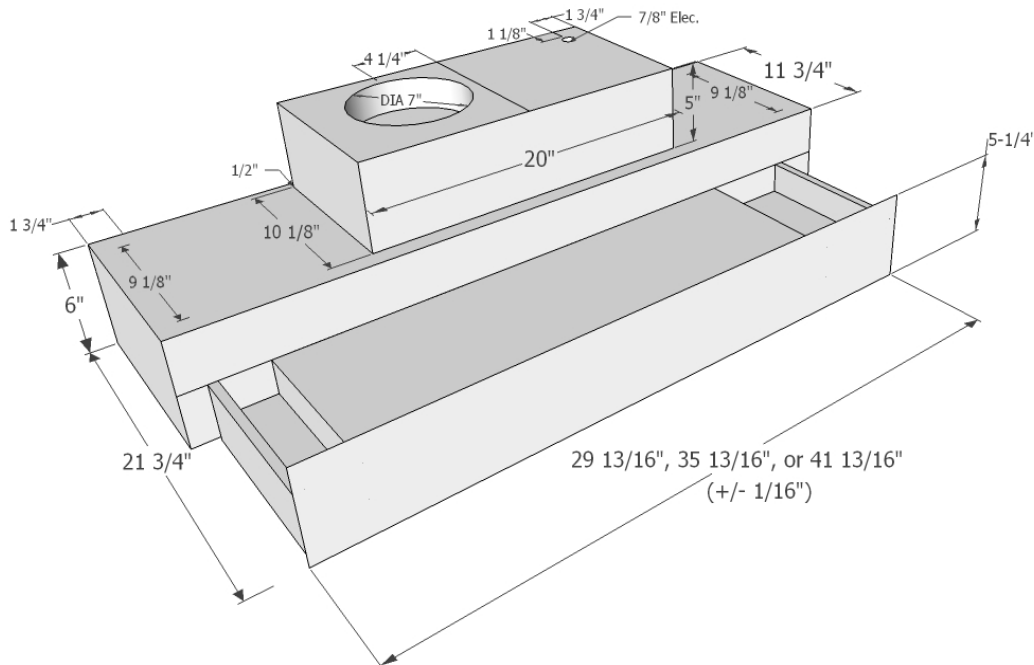

## TRANSITION

Example: 3036PS1-8-BL-SS  
Vent Size 8" Round x 3-1/2" High



**SEVEN YEAR, IN HOME, LIMITED WARRANTY, THE BEST IN THE INDUSTRY!**

All dimensions are (+/-) 1/16" and are subject to change. Drawings are not to scale.